

PENNSYLVANIA
FISH AND BOAT COMMISSION
TYLERSVILLE
FISH CULTURE STATION

TYLERSVILLE
State Fish Hatchery
Clinton County

Tylersville State Fish Hatchery

43 Hatchery Lane
Loganton, PA 17747
570-725-3965

Visitor Hours: Daily, 8:00
a.m. - 3:30 p.m.

Location: Approximately 7
miles east of Lamar near the
village of Tylersville in Clinton
County, Logan Township (see
10 on [Clinton County map](#)).

FISH SPECIES PRODUCED



brook trout



brown trout



rainbow trout



golden rainbow trout

Fish pictures from our [PA Fishes book](#).



The Tylersville Fish Culture Station (hatchery) was originally constructed in 1963 by the United States Department of Interior, Fish and Wildlife Service (USFWS) and was closed in 1977. In 1984, the Commission entered into a lease agreement with the USFWS to maintain and operate the facility. The hatchery is located on approximately 80 developed acres (125 total acres) with 5,000 feet of concrete linear raceways.

The water supply is a spring pool with 8 spring sources and infiltration of subsurface flow that originates from Big Fishing Creek.

Buildings include a hatch house/administrative office complex, maintenance garage/employee quarters building, and a pole building for vehicle storage.

HATCHERY STATS

- **Employees:** 12 full-time, 1 part-time
- **Annual Economic Impact for PA:** \$63,000,000
- **Average Fish Production:** 724,161 adult trout, 372,782 lbs.
- **Average Production Costs:** per fish = \$1.15, per pound = \$2.23
- **Visitor Center:** No
- **Average Annual Visitors:** 500

PHOTOS

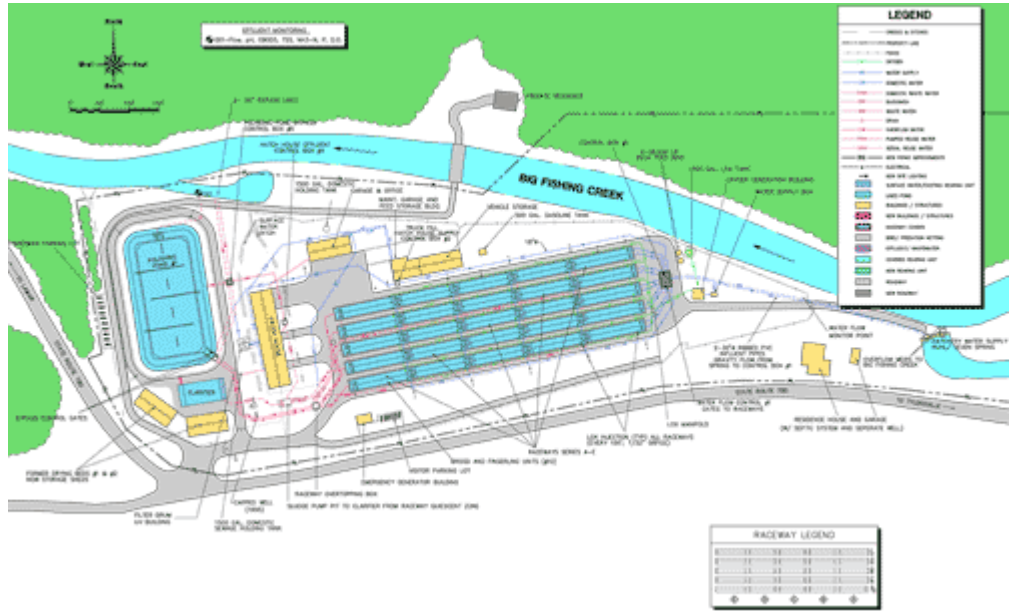

Tylersville Site Plan

Larger images of site plan: [GIF - 53 kb](#) or [PDF \(most detail\) - 582 kb](#)

